



INSTALLATION INSTRUCTIONS

# Roof

## PINK® BATTS® SKILLION ROOF INSULATION

### Installation Instructions

Correct installation with no compression, gaps or folds is critical to ensure Pink® Batts® skillion roof insulation performance is not compromised.

#### Safety:

Each installation is unique so prior to installation check for all hazards that may cause injury:

- Carry out any required repair work before starting installation
- Ensure there is adequate lighting to identify any hazards
- Treat all electrical cables as live, being careful not to cut or expose cables and wires
- Beware of other sharp objects (protruding nails, splinters etc.), pests (bees and wasps), loose boards and pipe work

**Note:** Seek professional advice if you are unsure how best to isolate the hazard or have a professional installer carry out the work on your behalf.

We recommend PinkFit® professional installers. PinkFit® are a nationwide network of professional installers who guarantee that their completed installation will meet the requirements of NZS 4246:2016.

For your local PinkFit® installer call **0800 746 534** or visit [pinkbatts.co.nz/installing-pink-batts/](http://pinkbatts.co.nz/installing-pink-batts/)

#### Installation:

Any slight irritation to exposed skin caused by the fibres in glass wool, or through their inhalation, is harmless and temporary.

However, for your comfort while installing, it's recommended you wear:

- Loose fitting work clothes which cover the arms and legs
- Covered shoes
- Dust mask
- Safety glasses

For safety while installing, it's recommended you use:

- Cut resistant gloves (if knife is used)

For an efficient installation, the following tools are recommended:

- Stable working platform
- Knife
- Tape measure

#### Installation Instructions

Confirm the correct product and R-value is used for the roof application. Refer to drawings/specifications where available. Skillion roof insulation may only be installed in roof cavities and is not suitable for installation in walls.

- Retrofit of insulation in skillion roof cavities is typically done when the roof cladding is removed
- Ensure the product is installed and all cavities dry. If the product is wet, replace before installing
- Friction fit the product between framing, ensuring there are no gaps, folds or compression of the product
- If cutting is required, cut oversize by 5mm to ensure friction fit
- Install to the outer edge of the top plate covering at least 50% of it
- Fit insulation tightly around all roof penetrations, vent pipes, etc
- Fit Pink® Batts® insulation beneath electrical wiring and plumbing where possible
- Maintain a 25mm gap clearance between Pink® Batts® insulation and roofing underlay. See Figure 1 for typical installations.

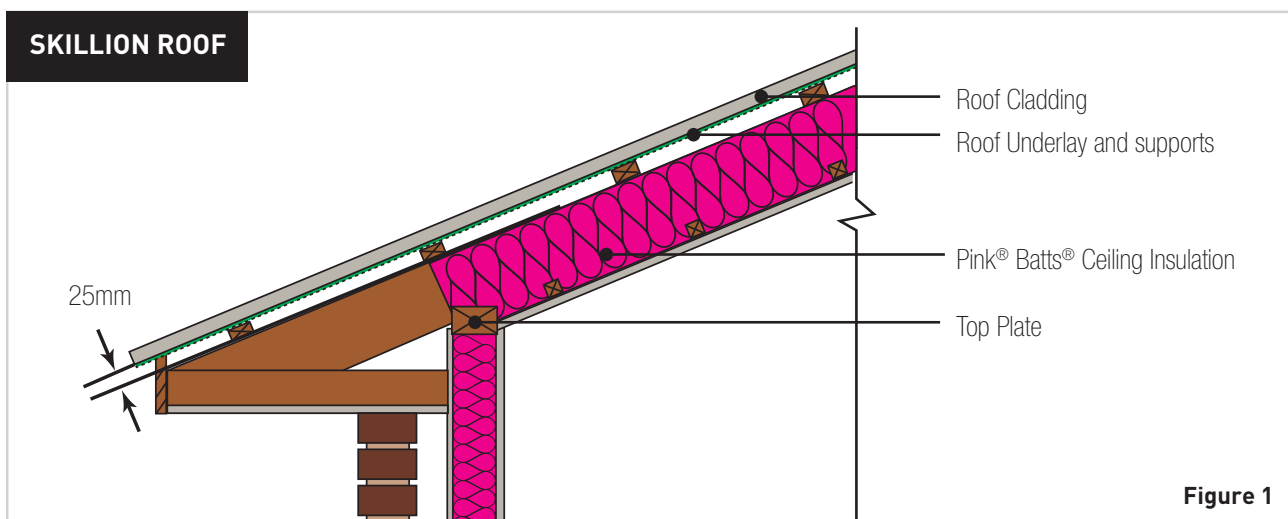

**Tip:** To verify Building Code Compliance, staple a product label and installer information at an easy to find location away from any hot items such as downlights or water cylinders. An alternative is to supply the information to the building owner or authorised person.

Refer to NZS 4246:2016 for further information related to the correct installation of insulation around electrical auxiliary devices and downlights.

**Caution:** Electrical cables and equipment partially or completely surrounded with bulk thermal insulation may overheat and fail. This applies to wiring installed prior to 1989.

## Clearances

Follow the clearances specified by the manufacturer; if they are not known then:

### ■ Recessed Luminaire

- CA rated recessed luminaires - Nil, however do not install insulation on top of the recessed luminaire
- IC rated recessed luminaires - Nil, insulation can be installed over the top of the recessed luminaire
- Unmarked - Minimum 100mm

### ■ Surface Mounted Luminaire - Minimum clearance 200mm; however it does not apply if the insulation is permanently shielded.

### ■ Controlgear

- If possible place it on top of the insulation and leave a minimum clearance of 50mm between controlgear and luminaire
- If not possible to place it on top of the insulation and leave 50mm from the insulation to the controlgear. Controlgear **shall not** sink into the insulation.

- Built in appliances - Minimum 50mm
- Enclosures containing electrical equipment - Minimum 50mm
- Fan/heat/light unit - Minimum 100mm
- Ventilation systems - Minimum 50mm
- Unducted mechanical fan units - Minimum 200mm
- Unducted passive vents that remain functional - Minimum 200mm
- Metal chimney and flues - Minimum 75mm
- Brick chimney - Minimum 50mm
- Roof underlay - Minimum 25mm

## Product Guide

	LIFETIME WARRANTY*	BRANZ APPRAISED	ENVIRONMENTAL CHOICE	GREENGUARD CERTIFICATION	CODE	SIZE (mm)	NOMINAL STABILISED THICKNESS* (mm)	NOMINAL TOTAL AREA PER PACK (m <sup>2</sup> )	APPROX TOTAL AREA PER PACK** (m <sup>2</sup> )
Pink® Batts® Skillion Roof R3.2	✓	✓		✓	7110232	1220 X 432	115	3.7	3.9
Pink® Batts® Skillion Roof R3.6	✓	✓	✓	✓	7110236	1220 X 432	165	6.3	6.6

# For full details of the Pink® Batts® Lifetime Warranty visit [pinkbatts.co.nz](http://pinkbatts.co.nz).

\* Stated thicknesses are maximum values.

\*\*Coverage relates to standard structure and actual coverage may vary.

## Storage and Maintenance

Pink® Batts® insulation should be protected from damage and weather. Store under cover in clean, dry conditions. The installed product should remain dry at all times. If the product becomes wet or damp, the source of dampness (e.g. leak in building) should be repaired and any wet or damp insulation should be removed and replaced with new insulation of an equivalent R-value.

## Disposal of bags

Recyclable LLDPE bags are used for packaging of Pink® Batts® insulation. These bags are categorised as Rec 4 and can be placed in a recyclable refuse collection bin. For further details download the relevant product data sheet from [pinkbatts.co.nz](http://pinkbatts.co.nz)

## Accreditations/Appraisals/Certifications



Tasman Insulation  
New Zealand Ltd Certified QMS



**DISTRIBUTED BY**  
Tasman Insulation New Zealand Ltd  
9-15 Holloway Place, Penrose, Auckland,  
New Zealand

This document supersedes all previous versions and may have been superseded; is a guide only and the purchaser should ascertain the suitability of this product for the end-use situation intended and when used in conjunction with other products; and is provided without prejudice to Tasman Insulation New Zealand Ltd (Tasman) standard terms of sale. Tasman retains the right to change specifications without prior notice. Refer to [www.pinkbatts.co.nz](http://www.pinkbatts.co.nz) or consult Tasman for further information. Do not use this product for any application not detailed in this document. All claims about this product are subject to any variation caused by normal manufacturing process and tolerances. The liability of Tasman and its employees and agents for any errors or omissions in this document or otherwise in relation to the product is limited to the fullest extent permitted by law. Except where the consumer acquires the goods for the purposes of a business, any rights a consumer may have under the Consumer Guarantees Act are not affected. The colour PINK and Pink® are registered trademarks of Owens Corning used under license by Tasman Insulation. Batts® is the registered trade mark of Tasman Insulation.



**Always.**