

NOTE:

1) DRAINAGE CAVITY NOT REQUIRED FOR STEEL, MASONRY, OR H5 TREATED CENTRE-POST.

2) IF CAVITY IS REQUIRED, REFER TO VENTCLAD CONSTRUCTION DETAILS.

3) DEPENDING ON DIMENSION OF CENTRE-POST, ADDITIONAL BLOCKING OR PACKERS MAY BE REQUIRED.

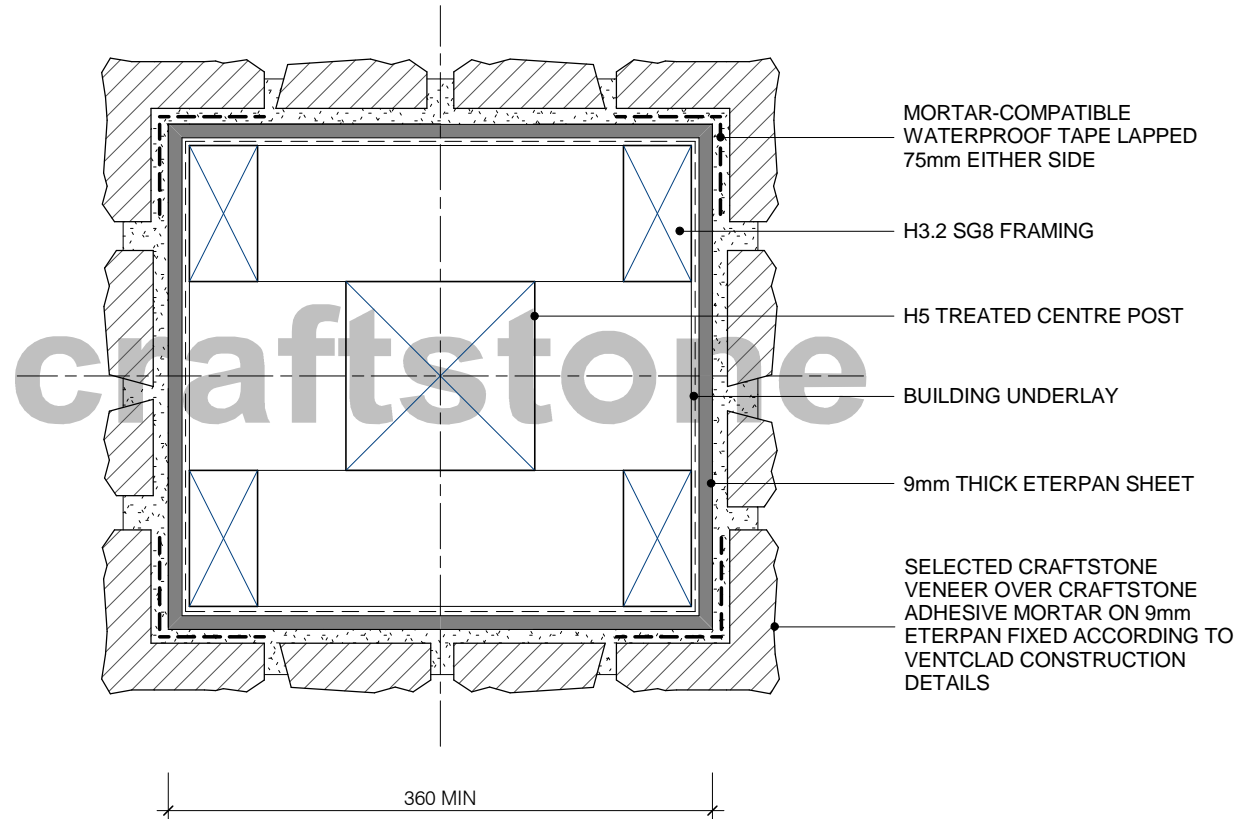

[WWW.CRAFTSTONE.CO.NZ](http://WWW.CRAFTSTONE.CO.NZ)



**COLUMN FRAME-UP**

**K2**  
SHEET

1 : 5 @ A4  
SCALE

10/16/12  
ISSUED

COPYRIGHT CRAFTSTONE NEW ZEALAND LIMITED  
CRAFTSTONE NEW ZEALAND ACCEPTS NO LIABILITY FOR DRAWINGS SUBMITTED TO COUNCIL

6C PIERMARK DRIVE, ALBANY, AUCKLAND, NEW ZEALAND - P: 09 447 3918 F: 09 447 3919  
P.O. BOX 302-613 NORTH HARBOUR 0751, AUCKLAND, NEW ZEALAND