

Disclaimer: This drawing has been issued as a guideline. The drawing illustrates the plaster in relation to other building components. Refer to substrate manufacturers details.

**Brick**  
**masonryplast®**

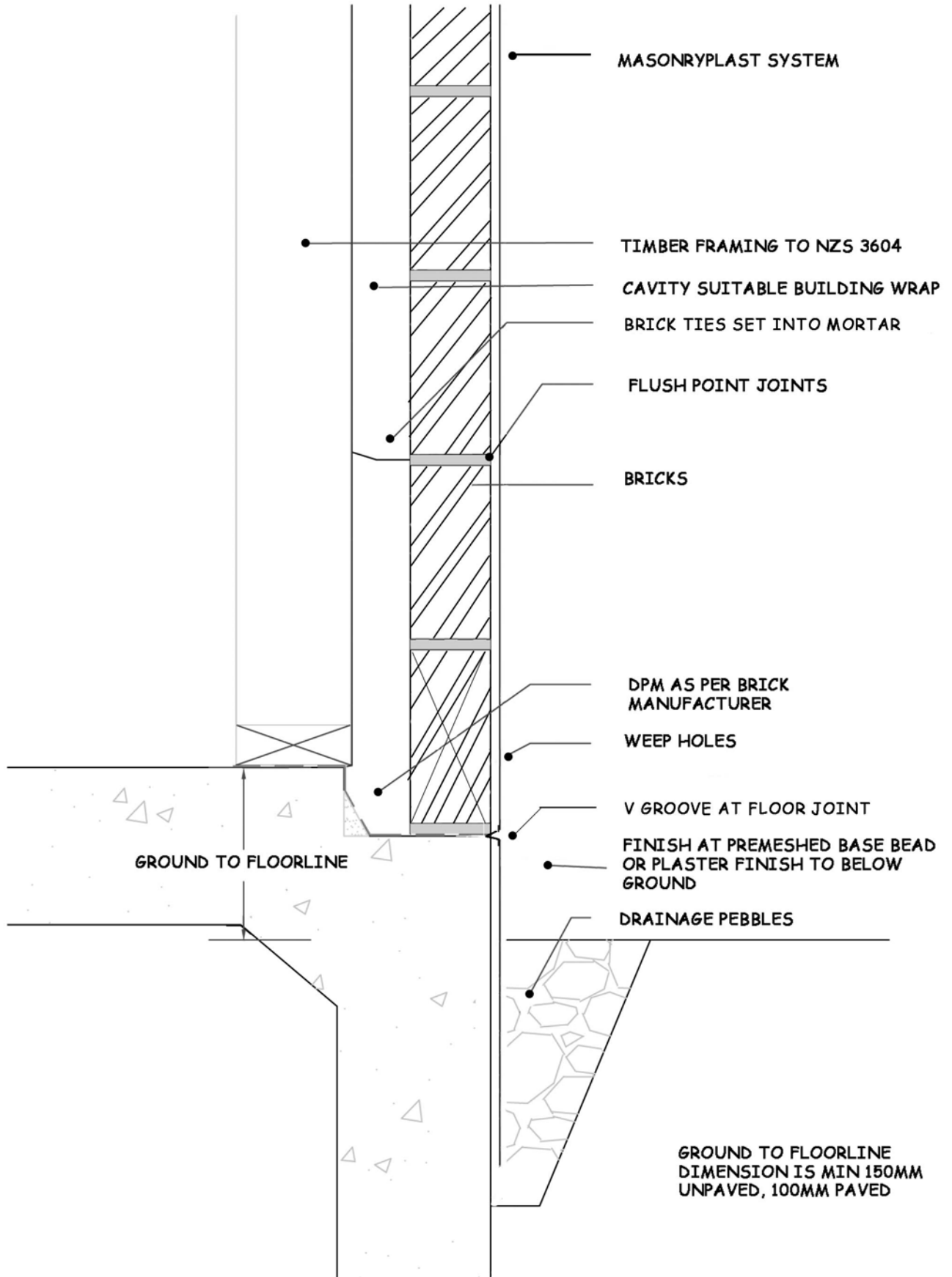

**05 FOUNDATION**

This drawing is protected by copyright © PLASTER SYSTEMS LTD

[www.plastersystems.co.nz](http://www.plastersystems.co.nz)

September 2007

© Copyright 2007