

PDL 800 MODENA SERIES

GENERAL INSTRUCTIONS

- It is illegal for persons other than those authorised by legislation to work on the fixed wiring of any electrical installation.
- All installations must be in accordance with local and state Electrical Wiring Regulation and Building Codes of Practice.
- **CLEANING** - To clean, simply use a cloth dampend with water only. Cleaning agents are not recommended as their use may harm the product and void warranty claims.

2. Modules should be clipped into Grids before screwing product to the wall.

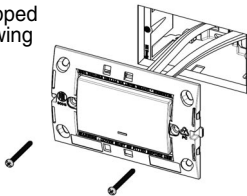

FITTING INSTRUCTIONS

1. Modular accessories can be wired before or after clipping into a Grid.

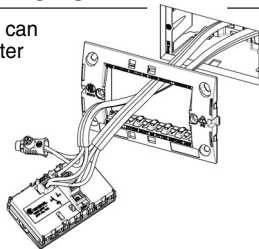

3. Once the Grid is firmly attached to the wall the cover can be clipped into place.

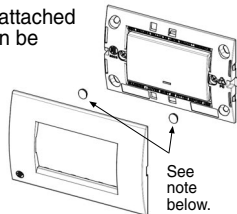

Note: When fitting a metal plated cover to a grid that has been mounted using the centre mounting screws, screw caps must be fitted.

COVER REMOVAL

To remove cover insert a flat blade screwdriver between Cover and Grid tab and gently lever apart.

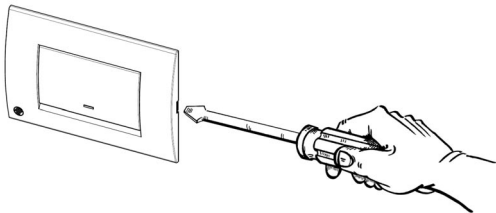

MODULE REMOVAL

To remove modules use ejector tool as shown below.

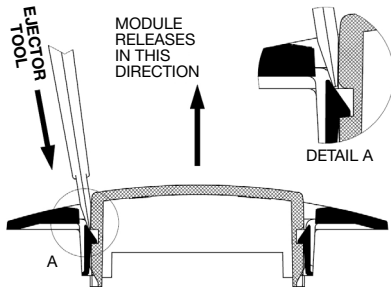

P D L

New Zealand Head Office:
PO Box 15 355, New Lynn, Auckland, New Zealand
Telephone +64-9-829 0490, Fax +64-9-829 0491
www.schneider-electric.co.nz



PDL Electrical Products are
manufactured by



Electrical Products

PDL Industries Australia Pty Ltd
Locked Bag 5500, Baulkham Hills Business Centre
Baulkham Hills NSW 2153 Australia
Freephone 1300 735 266, Freefax 1300 735 329
Telephone +61 29851 2666, Fax: +61 29851 2695
www.pdl.com.au