

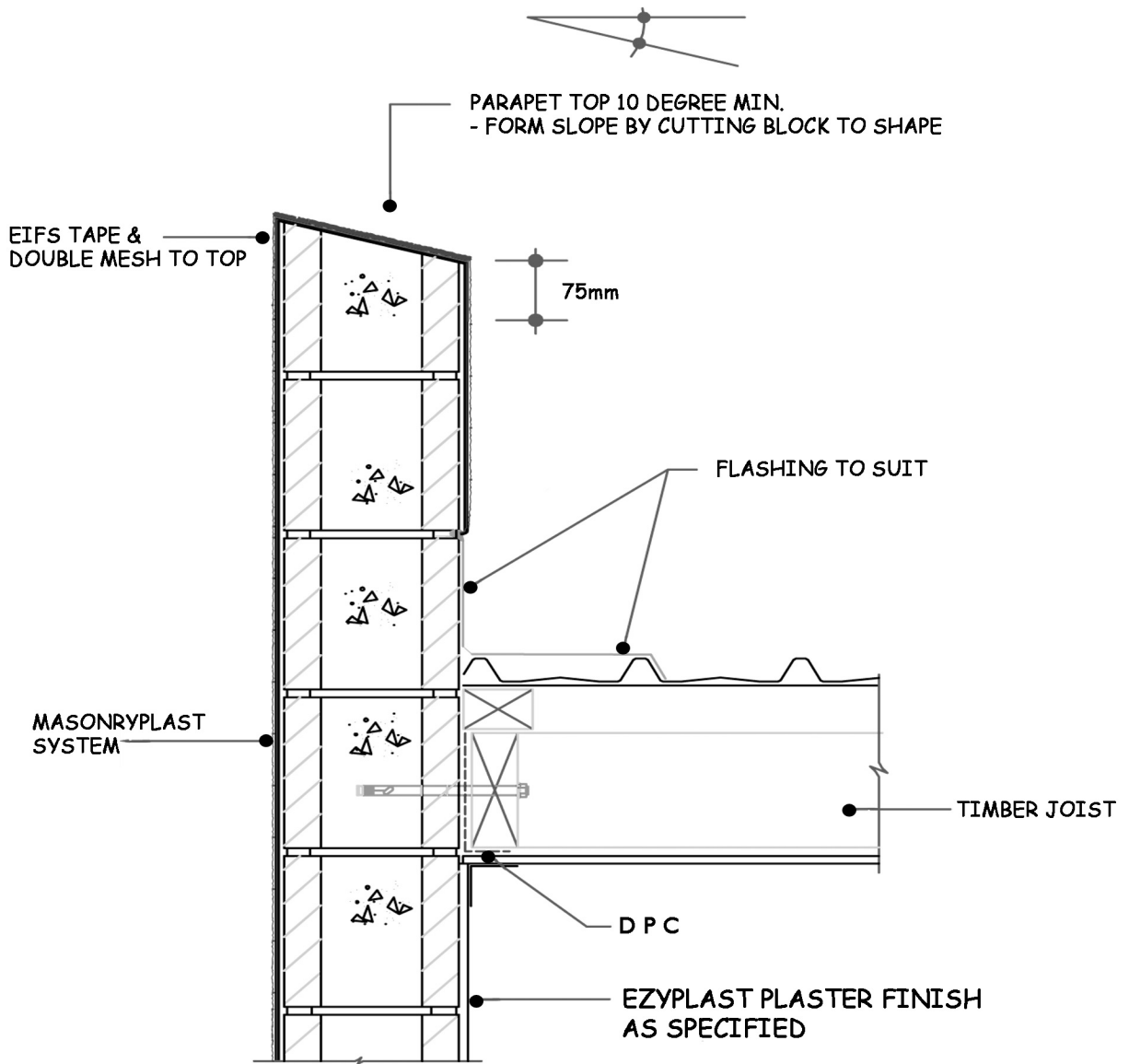

Disclaimer: This drawing has been issued as a guideline. The drawing illustrates the plaster in relation to other building components. Refer to substrate manufacturers details.

**Block**  
**masonryplast<sup>®</sup>**



PARAPET WALL / ROOF / DECK DETAIL

**6 CONCRETE BLOCK PARAPET TOP**

This drawing is protected by copyright © PLASTER SYSTEMS LTD

**[www.plastersystems.co.nz](http://www.plastersystems.co.nz)**