

BGC

Fibre Cement

Note 1:
BGC Durasheet™ must be fixed vertically with all sheet edges sealed before fixing.

Note 2:
If timber studs are placed @ 400 c/c, no intermediate battens are required, nogs may be placed @ 1200 c/c max, 100mm long packers will be required between battens as shown

Note 3:
Horizontal packers are not to be installed on the sill trimmer framing within 100mm of the window opening edge.

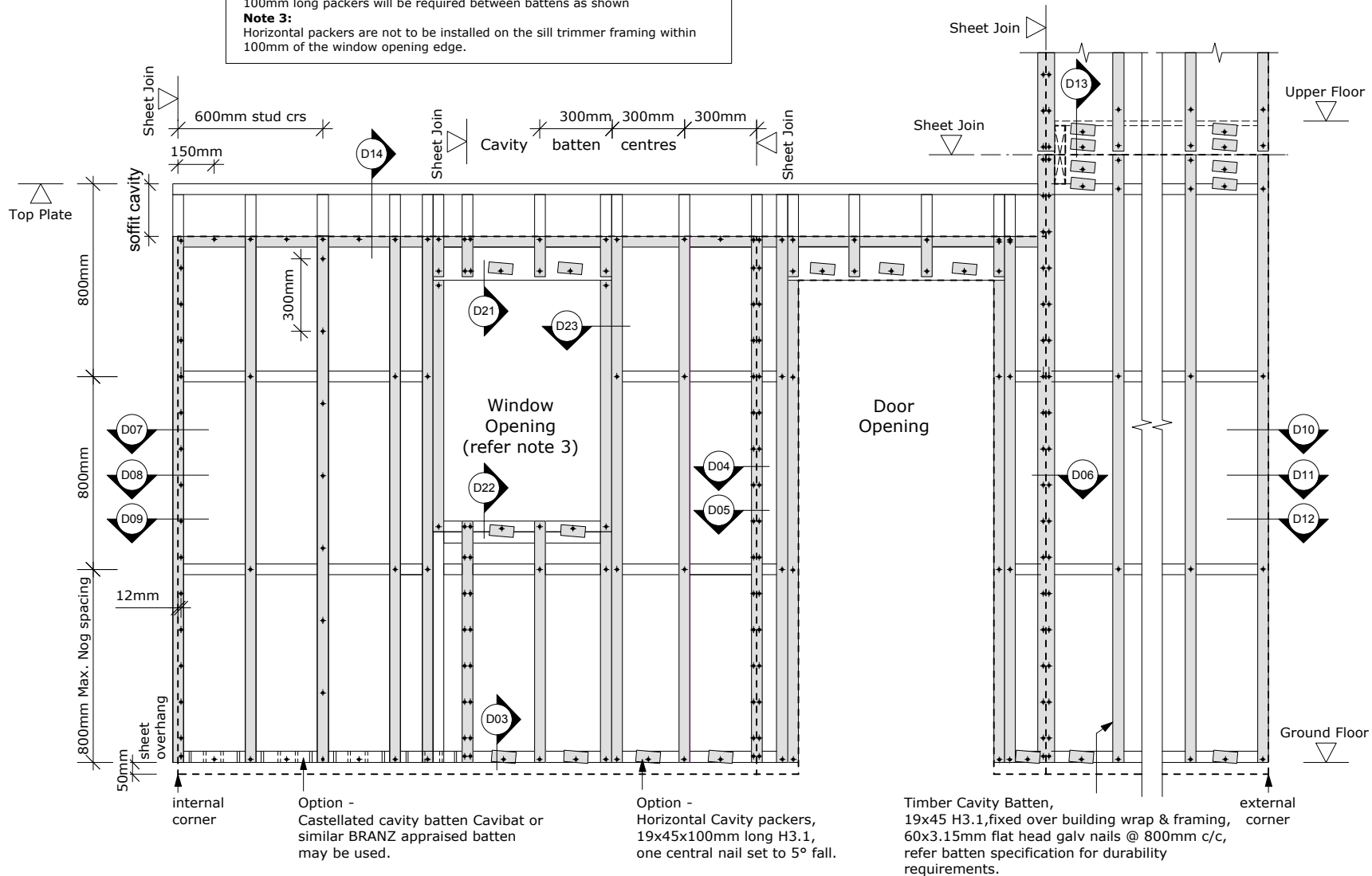

PROFILE BGC Durasheet™

DETAIL Wall Elevation

DATE Feb 2010

SCALE 1:25 @ A4

DETAIL NO. D00